

Master Planning Committee Meeting #11 Notes

Benson Polytechnic High School
March 23, 2017



MEETING DETAILS

Meeting Location:

Benson Polytechnic High School,
546 NE 12th Ave, Portland, OR 97232

Attendees:

Portland Public Schools (PPS):

Jerry Vincent, Office of School Modernization Chief
Jen Sohm, Project Manager
Jeanne Yerkovich, Director of Career Learning/CTE

Master Planning Committee Members:

Curtis Wilson Jr., Principal
Paul Anthony
Simon Criswell
Kevin B. Clark
Reuben Gilmore
Tammy Hite
Luke Hotchkiss
Rob Johns
Dave Ketah
Jacob M. Masters
Jim Piro
Julie Tonroy
Richard Spies
Irina Phillips

Public

James Walton, Benson Student
Jeff Strachan, Alumni
Teresa Tran, ASB President
Moses Tran, ASB Treasurer

Design Team

Lorne McConachie, Bassetti Architects
Joe Echeverri, Bassetti Architects
Cary Dasenbrock, Bassetti Architects
Dianna Montzka, Bassetti Architects

Pre - Design Goals:

Identify the vision, philosophy, and objectives of the school.

Provide a consistent and diverse voice for user groups in the pre - planning phase of the project.

Prioritize the objectives to attain cost certainty for the project moving forward.

Agenda

6:00- 6:20 5 min	Update Project Update - Portland Public Schools + Industry Outreach Update + Student Engagement Update + Educational Specification Update
5 min 10 min	Brief Recap - Scheme K Design Refinement - Scheme L
6:20 - 7:45 45 min 20 min	Design Refinement (Small Group Activity) Scheme L Review Report Back + Whats working (+), what needs improvement (Δ)
20 min	MPC Group Discussion
7:45 - 8:00 5 min 5 min 5 min	Wrap-Up Subcommittee Report Public Comment Closing Thoughts & Next Steps

Notes Issued Date:

March 29th, 2017

PROJECT UPDATE

Tasks since last MPC

- + Modified Scheme K resulting in Scheme L
- + Student Outreach at NW Youth Careers Expo
- + Consolidated industry partners connections list
- + CTE Advisory Committee survey released
- + Equipment survey and program scenarios reviewed with teachers
- + Scenario plans updated

Tasks through May bond

- + Expand survey to other partners
- + Garner input for Ed Spec development
- + Student information gathering at lunch: April 4th and 5th
- + Student Facebook survey
- + Room data sheets and program summary draft to be issued to MPC for review in April

After bond, if "approved"

- + Coordinated industry outreach and continued input from industry partners
- + Focused review of educational specifications with industry partners as details are developed
- + Reconciliation of systems with budget
- + Student focus groups
- + Identify student process, integrate into design process



SCHEME K OVERVIEW AND ACTION ITEMS

1. Refine clarity of circulation and access to daylight for every space:
 - + Explore a connection of the North and South wings with a bridge on the East edge.
2. Explore the Commons proportion and shape:
 - + Push the Commons North to create a more cohesive core with views from the second floor and better access to daylight for classrooms around the courtyard.
 - + Create a stronger connection to the south field access. Address concerns over trash and service deliveries at that location.
3. Landscape:
 - + Provide two driveways in the CTE courtyard to create a fluid path of in and out car circulation.
4. Enhance vertical connections with two-story circulation spaces and/or learning spaces.

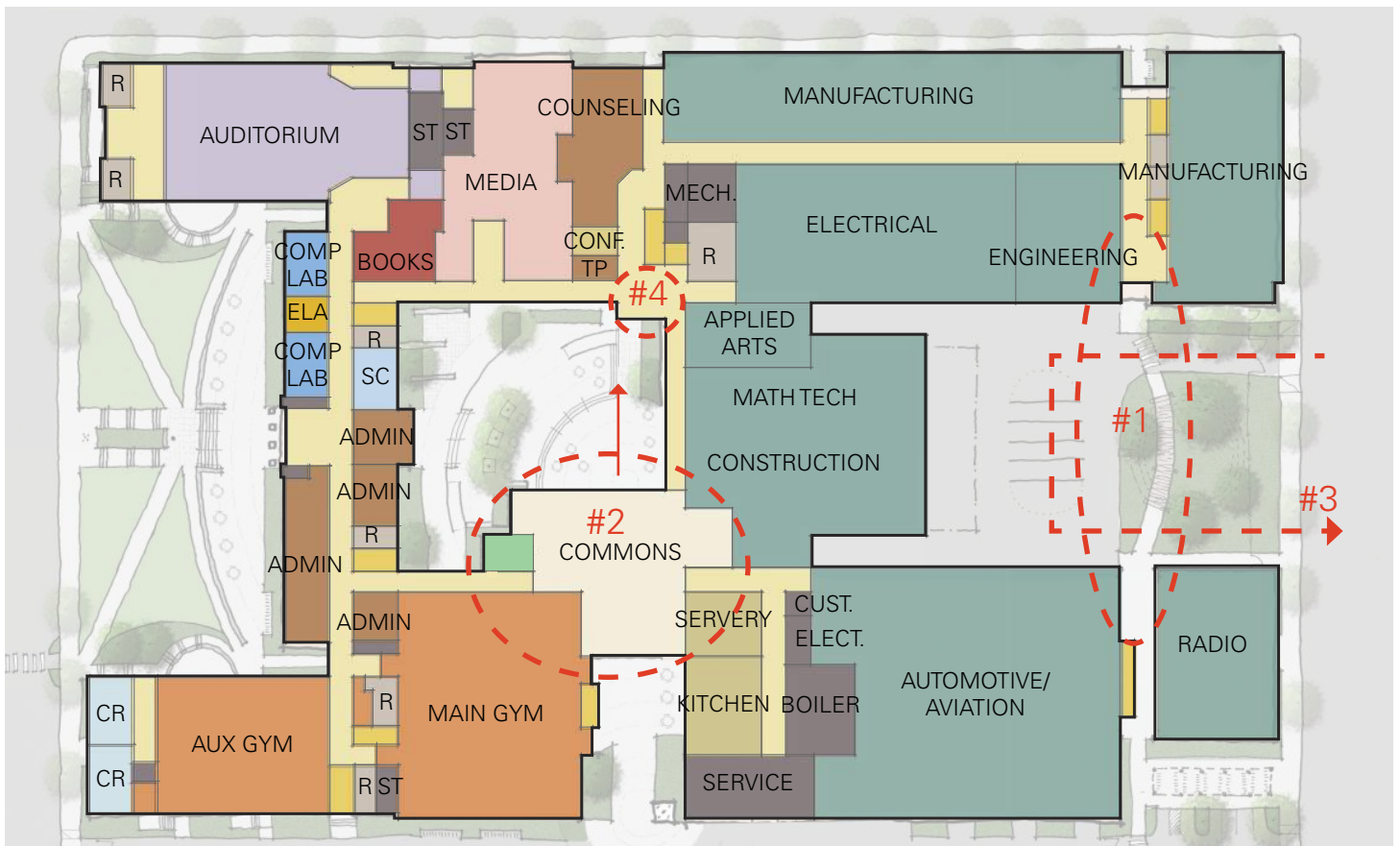

BUILDING STUDIES - SCHEME L

Scheme L Big Ideas

- + Stretch Commons north to connect the north and south wings
- + Protected social courtyard at the center, shared work courtyard to the east
- + Athletics entrance court to the south
- + Efficient service access for whole school and CTE uses
- + Enhance daylighting, transparency, and natural ventilation
- + Flexible adaptable spaces
- + Integrate academic programs and CTE programs through vertical relationships
- + Maintain historic structures and facades at the perimeter of the site
 - + Enhance primary defining characteristics of the school as a landmark
 - + New additions juxtapose historic character and polytechnical education in the 21st century

+ Positive

- + Digital media makes sense in the lower level
- + Plug and play of programs is evident and shows the flexibility of spaces being considered
- + CTE spaces located away from radio tower is good
- + Community room location at front of school is good
- + Keep the 3rd computer lab in the media center
- + Circulation and flow through school is working well – connection of north and south CTE wings at the east end of the school.
- + Social courtyard space is good addition from previous masterplan schemes
- + Improved security conditions at east edge of CTE courtyard
- + North wing location of Health Clinic is good
- + Student space flowing from Commons out into and across CTE courtyard is working well.

General Comments

- 16' potential clearance for house deliveries in the CTE courtyard - consider this for the pedestrian bridge.
- Consider PV panels and storm water treatment as teaching tools.
- Prepare structure of new building to be able to hold PV on roof
- Potential for a wind turbine to be donated from industry partners
- Security considerations and separation of pedestrian path and Auto/Aviation vehicle access along south edge of SE CTE wing (Auto/Aviation).
- Don't let CTE courtyard turn into a sea of asphalt
- Explore the extent of electrical shielding needed in CTE spaces.

Δ Change

- Shift Automotive wing further south to reduce pedestrian walkway and gain additional space in work courtyard
 - Integrate radio tower
 - Proximity to courtyard
- Sound in CTE courtyard is a concern for classrooms above
- Interior hallway connection across, but exterior to the Auto shops, is desired
- Move Architecture to the NE part of the north wing
- Architectural Design prefers more direct adjacency to Construction/Math Tech
- Consider shifting the 2nd floor north wing further north to gain more south facing rooftop
- Explore more visual connections in social courtyard to CTE spaces. There could be demonstration spaces rather than computer labs off of the commons
- Shift Math Tech north. This would result in a larger outdoor work area and south light
- Have demonstration spaces at the front of the school to showcase work
- Increase visibility from staircases into CTE and classroom spaces
- Create views into CTE courtyard from north hall at the social courtyard
- Think more about view corridors
- Applied Arts needs to be adjacent to manufacturing for welding
- Consider vehicle flow, pedestrian, and bike access along NE 12th
- Digital Media needs closer adjacency to Radio
- Consider alternative arrangements for Construction and Math Tech so as to allow service needs to be met in CTE courtyard
- Explore alternative layouts for Auto/Aviation CTE that might allow fuller use of existing SE CTE structure
- Explore costs of Science labs being on the first floor rather than the 2nd floor and look at the plumbing vs. vent cost of being on the 2nd floor.
- Make sure the roofs are equipped for future solar panel use
 - Talk with NW Solar Resource Center as a resource
 - There is a policy for payback from solar
- Band room similar to Roosevelt High School is desired
- Consider a car pull out off of 12th ave for kid drop off to reduce traffic

SCHEME L DIAGRAMS



SECOND FLOOR



GROUND FLOOR

SCHEME L DIAGRAMS

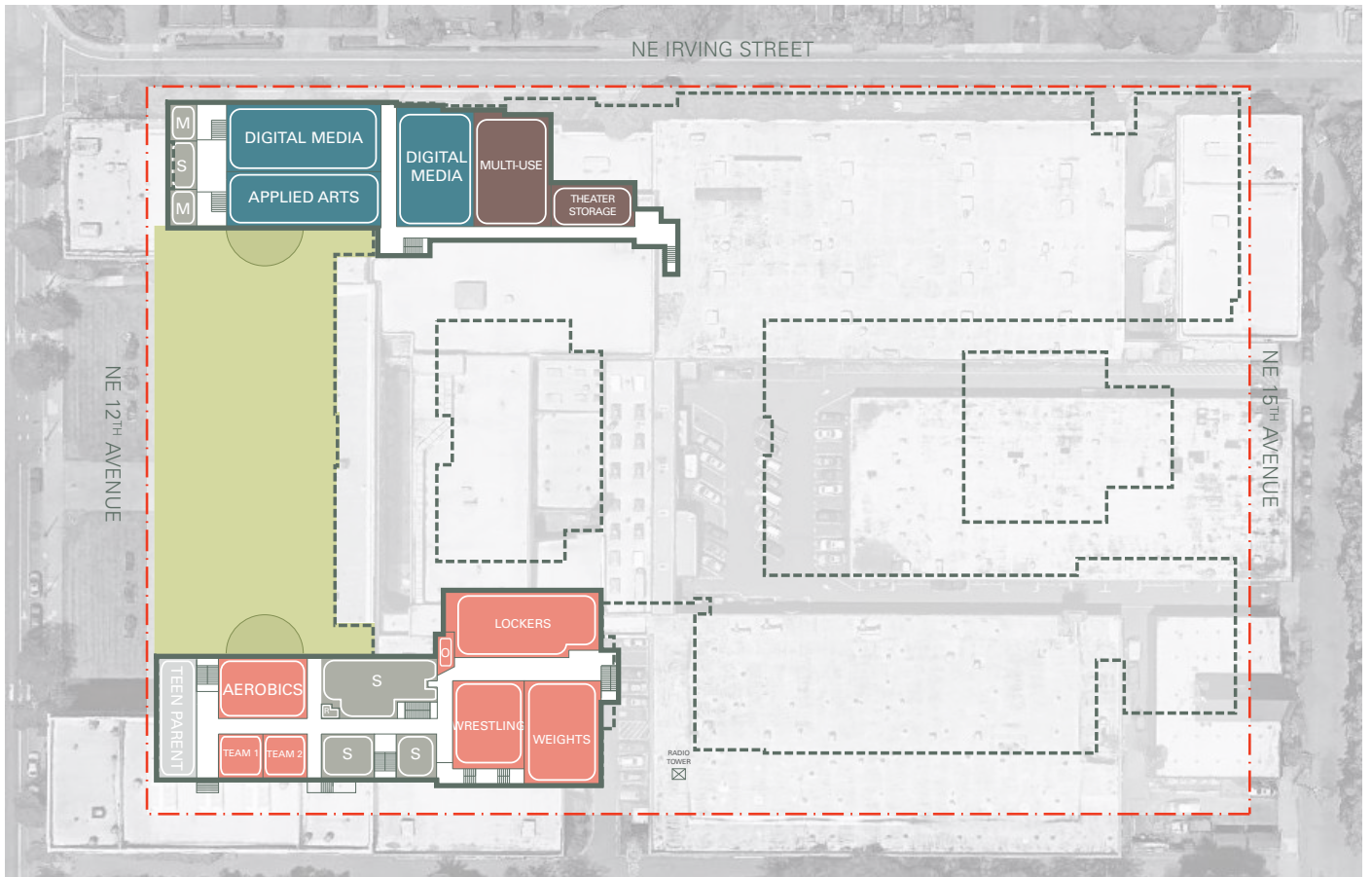

LOWER LEVEL OPTION 1

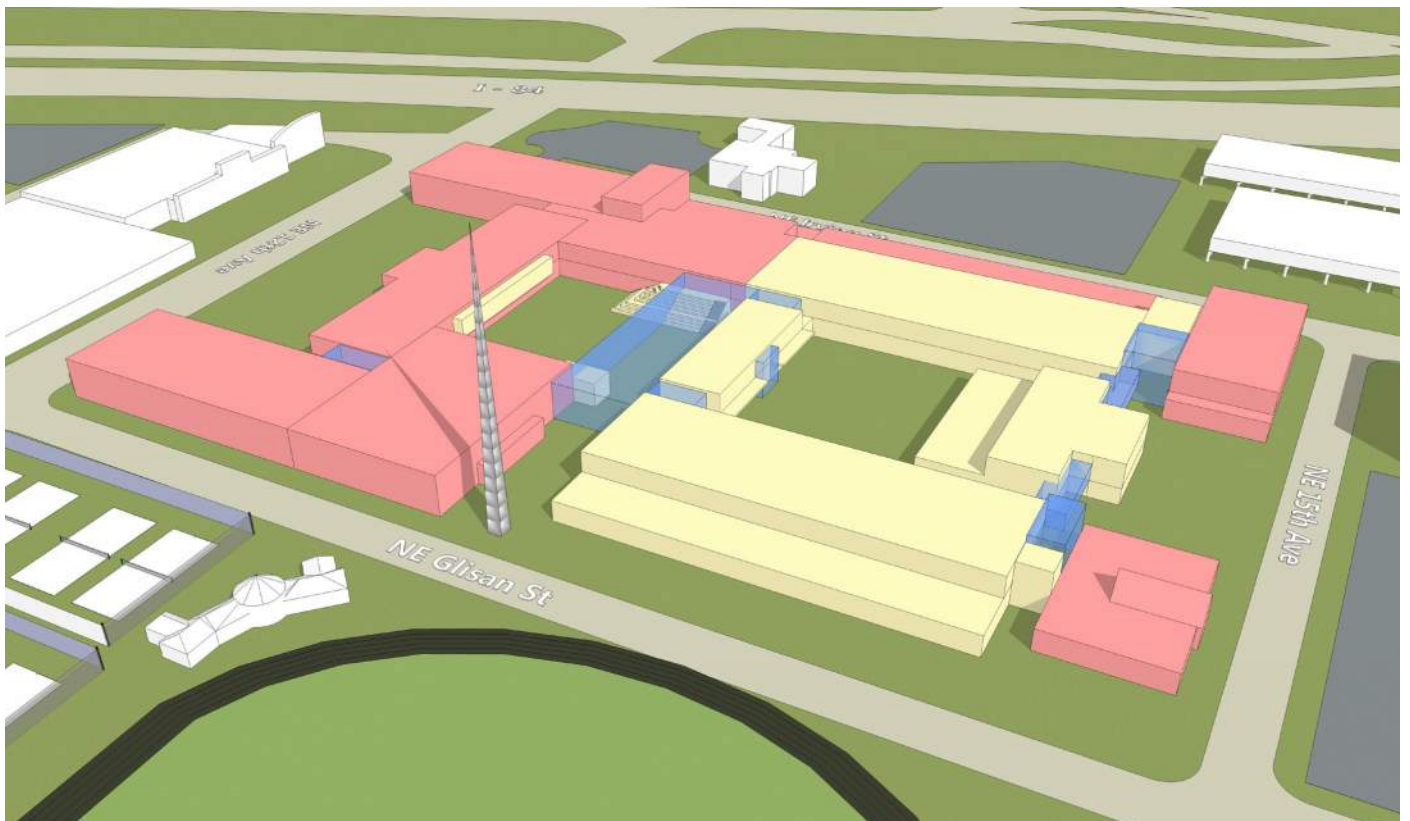

3D MASSING

CLOSING THOUGHTS

To close the meeting, each MPC member shared a positive (+) and a change (Δ) on Scheme L with the group.

+ Positive

Δ Change

Irina Phillips:

- + The commons location is working well, it makes a good southern connection to the field and a good vertical connection with the learning stair.

- The setback of Automotive and the second floor south wing is not convincing yet.

Richard (Dick) Spies:

- + There is a nice balance of open spaces.
- + The circulation diagram is working more cohesively.

- It would be interesting to have more information within the landscaping elements and how student work can be showcased in the courtyards.
- More work needs to be done on vertical visual connections

Simon Criswell:

- + The entryway is working well.

- The school district and architects should really consider gender neutral locker rooms in addition to gender neutral restrooms.

Jacob M. Masters:

- + Art and digital media in the lower level is working well.

- The elevator in the middle of the hallway near counseling needs to be changed.

Luke Hotchkiss:

- + The size and security of the CTE courtyard is working well and the absence of parking is essential in that courtyard.

- There are concerns with the level of sound happening in the CTE courtyard and how that will affect the classrooms above.

Reuben Gilmore:

- + The flow of paths throughout the school are working well.

- It would be nice to see the south wing rooftop be an inhabitable outdoor space

Curtis Wilson Jr.:

- + The wellness center on the ground floor next to counseling is a great location

- No changes to comment on.

CLOSING THOUGHTS

+ Positive

Julie Tonroy:

- + The transparency of the entryway and circulation are working well.

Δ Change

- No changes to comment on.
-

Kevin B. Clark:

- + The circulation, CTE courtyard, and wrap-around service access are all working well

- There are some concerns with unknowns at this point in the process, like how will the rooftops be used.
-

Tammy Hite:

- + No positive feedback to comment on.

- There are concerns with the CTE courtyard turning into a parking lot.
 - It is important to consider the school uses after hours, what spaces are needed for those activities, and how they will be zoned and secured from the rest of the school.
-

Dave Ketah:

- + The circulation has really improved.

- There are concerns with the practicality of construction costs and science labs being so spread out throughout the building.
-

Rob Johns:

- + No positive feedback to comment on.

- Math-Tech could be rearranged with Architecture to create stronger proximity connections.
 - There are still concerns with the traffic on 12th Ave and one solution includes a turn around/drop off area where the front lawn currently is.
 - Digital media could benefit from being closer to Radio
-

Jim Piro:

- + The design is all coming together nicely.

- No changes to comment on.

PUBLIC COMMENT

James Walton, a Benson student, shared two Δ 's with the group:

- Shift Automotive wing further south to reduce pedestrian walkway and gain additional space in work courtyard.
- Band room is needed.

A Benson Tech alumni, Jeff Strachan, added that the group is touching all the bases and gave his encouragement.



PPS COMMENT

Jeanne Yerkovich, Director of Career Learning/CTE for PPS, shared the hiring of Jay Keuter, CTE Strategic Business Partnerships Manager for PPS, who will play a major role in developing business partnerships for the district.



DESIGN ACTION ITEMS

The design is on the right track and the consensus is that the building layout and circulation is working well. Minor modification to be explored include:

1. Creating stronger connections between Digital Media and Radio, and Architecture with Construction than what is shown currently.
2. Updating the landscape plan to integrate with the current layout.
3. Refinements of circulation paths in regard to view corridors and gathering spaces.
4. Continue to explore efficiencies to reduce area and maintain budget.
5. Integrate strategies for flexibility and adaptability into Educational Specification currently in development.
6. Discuss drop-off area off of NE12th Avenue with district's traffic engineer.

